

Remote Access

Imprivata Self Enroll and Accessing Remote Access

Remote access to Temple Health System applications will require your network logon plus a second authentication.

Imprivata is the phone application that will provide the second authentication code. Imprivata ID is a free app. This document details how to download and install the Imprivata app.

TUHS Supplied Phone

If you are installing the Imprivata ID app on a TUHS supplied phone, use the MAAS360 catalog to download the Imprivata ID app.

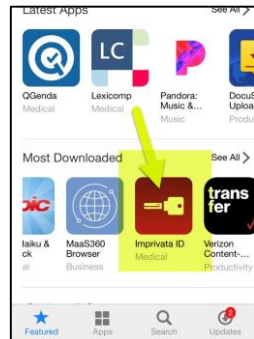

Personal Phone

If you are installing the Imprivata ID app on a personal phone, use the Apple App catalog for iPhone or Google Play for Android phones to download and install the Imprivata ID app.

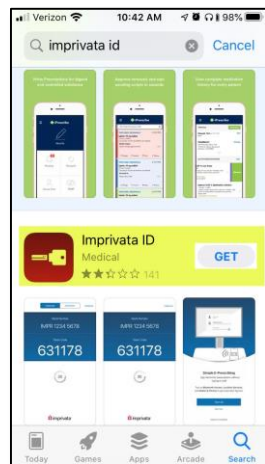

Remote Access

Imprivata Self Enroll and Accessing Remote Access

Imprivata Set up:

1. Open the Imprivata ID app after it is installed.
2. In the first window choose the option **"This is my first time"**

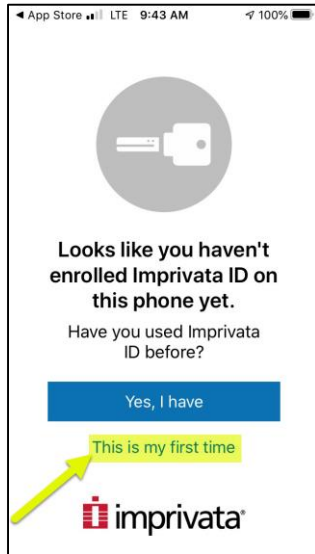

3. Choose **"Turn on"** for **Fast Access** and **"Not now"** for the additional prompts as shown below.

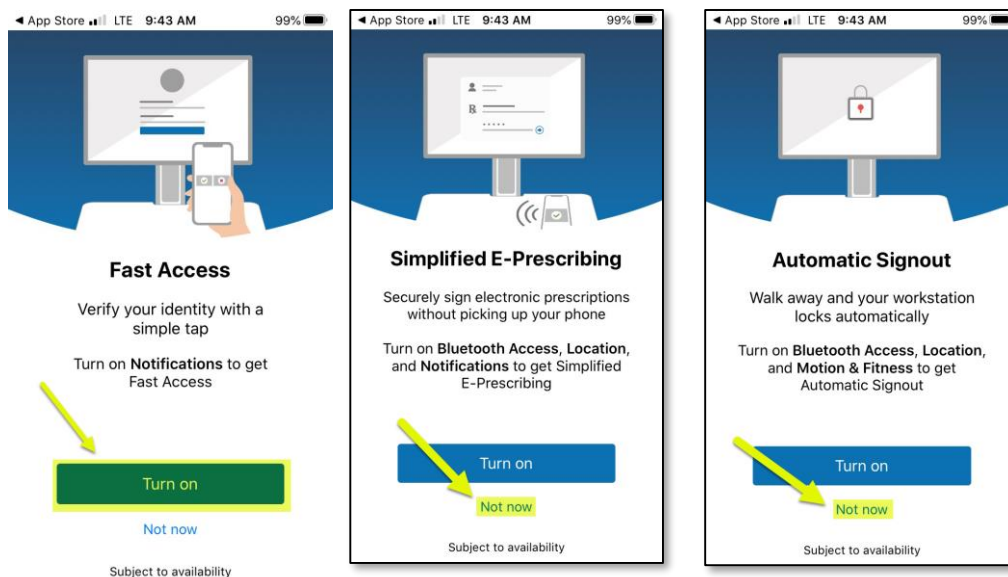

An Imprivata icon will display on your phone desktop.

Remote Access

Imprivata Self Enroll and Accessing Remote Access

Turning on Notifications for Imprivata App (iPhone):



1. Open **Settings** on your iPhone.
2. Scroll down and tap **Notifications**, then **Imprivata**.

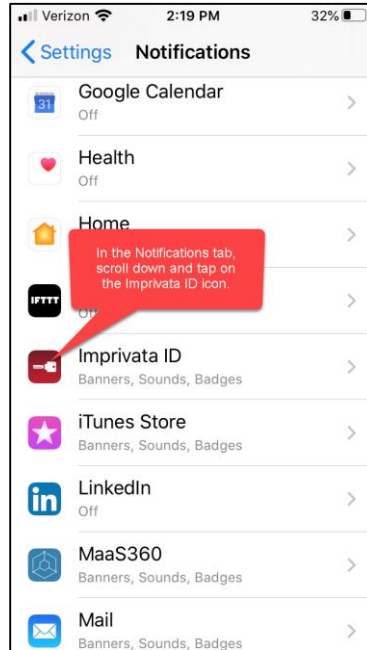
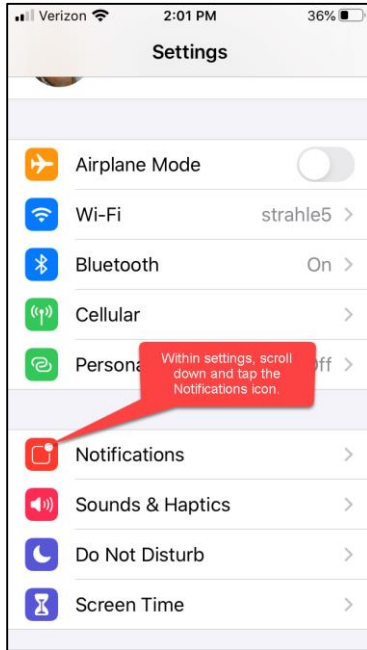

3. Turn on **Allow Notifications** and select **Lock Screen, Notification Center, Banners, Sounds and Badges**.

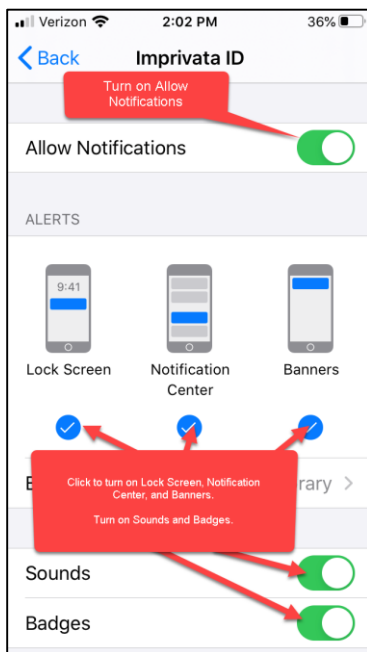

4. Exit **Settings**.

Remote Access

Imprivata Self Enroll and Accessing Remote Access

Logging in to Remote Access:

1. From your web browser, type in <https://remoteaccess.templehealth.org>.
2. Enter in your TUHS network user ID and password and click **Log On**.

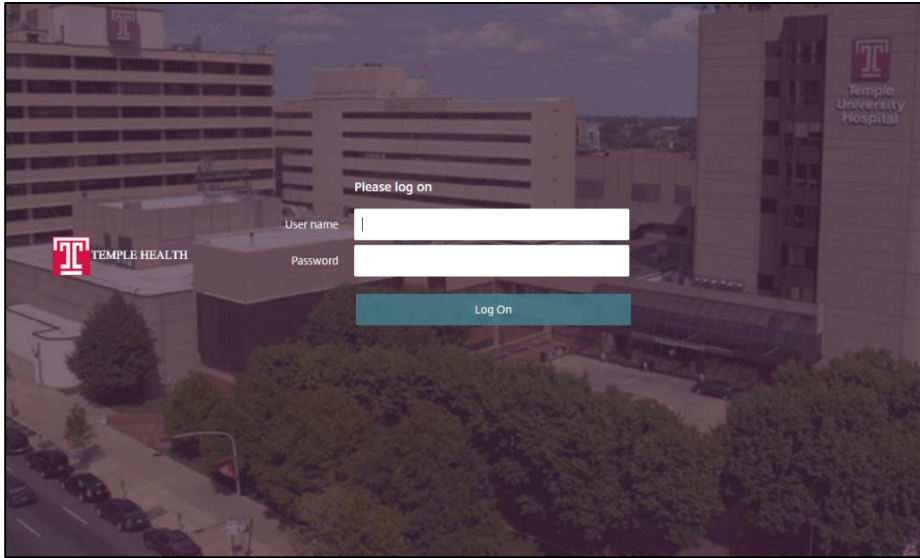

3. You will be presented the following screen:

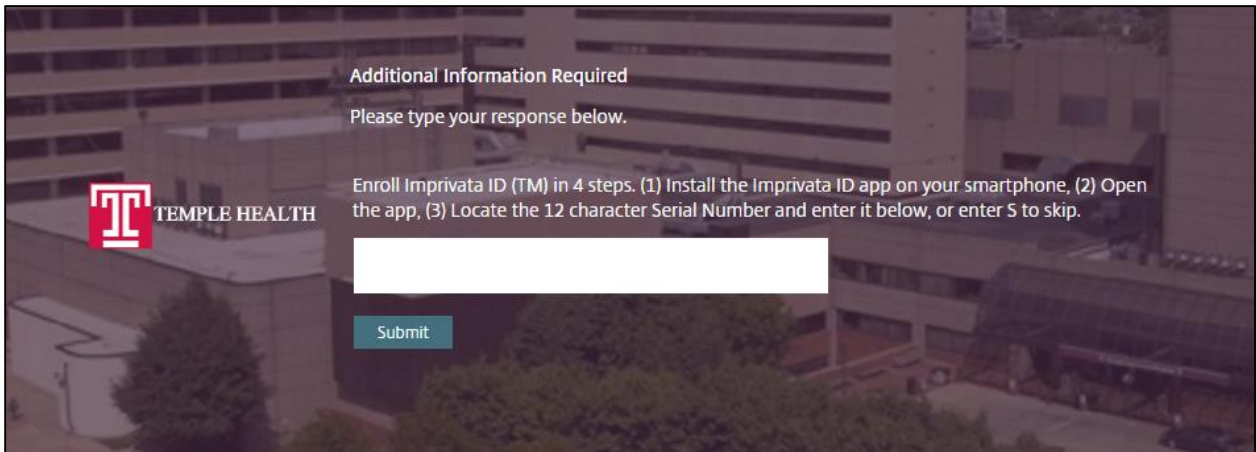

4. Follow the directions on the screen. (Per instructions above you should have downloaded the Imprivata ID app from the App Catalog onto your Phone.

Remote Access

Imprivata Self Enroll and Accessing Remote Access

5. Open the Imprivata ID app once it is installed on your phone. It will look something like this. You will need both the **Serial Number** and the **Token Code**.

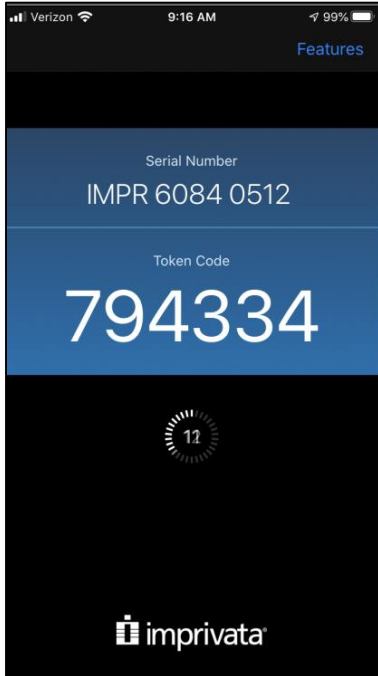

6. Enter the 12-character Serial number displayed in the Imprivata ID app, including the letters **IMPR** and click **Submit**.
7. Enter the **Token Code** displayed on the Imprivata ID app and click **Submit**.

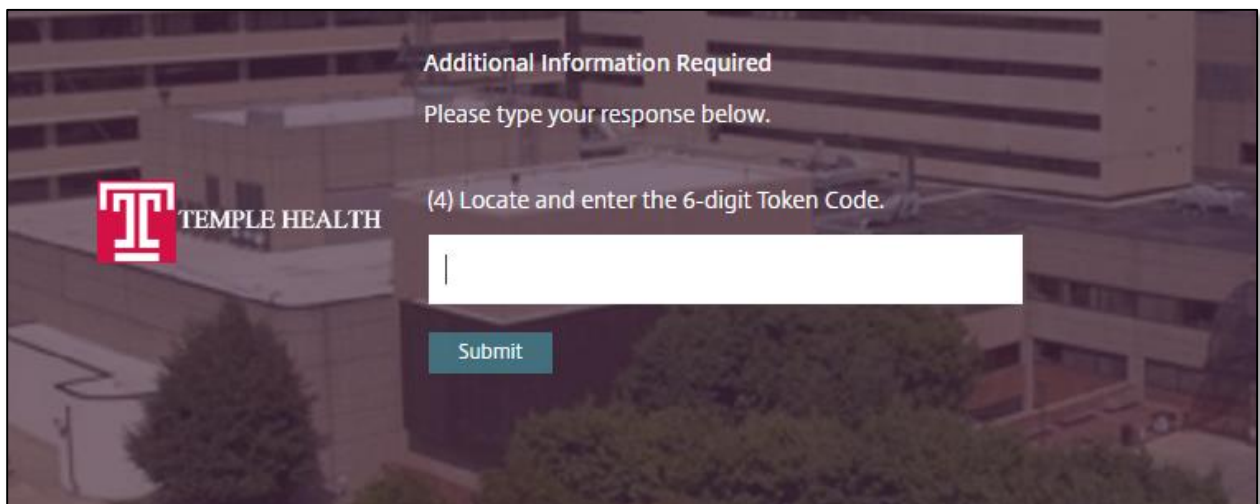

Once you have logged into the Access Gateway

1. If you have permissions to launch the Split Tunnel VPN you will see the following choices page:

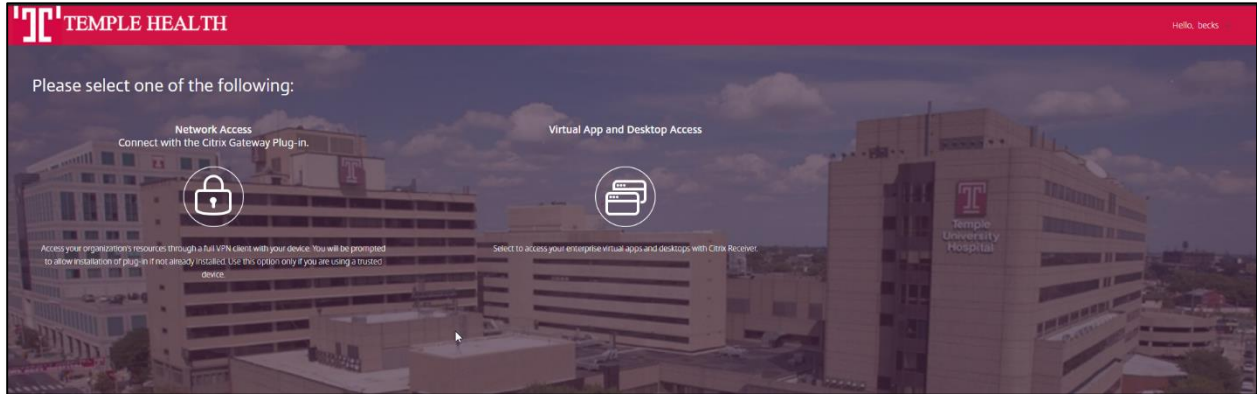

2. The **Network Access** button will launch the Citrix VPN client while the **Virtual App and Desktop Access** button will take you to the Citrix Storefront where you can launch all the published applications you have permission to launch.
3. If you connected via a non-Internet Explorer browser, you may see the following page before the Storefront loads:

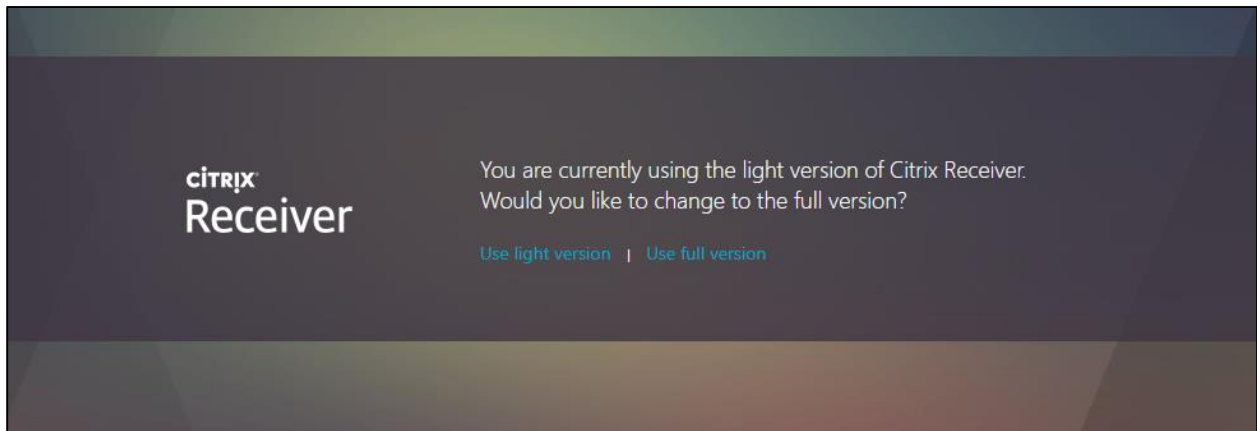

4. If you see this screen and you have the Citrix Receiver installed on your computer, click **Use full version** option.
5. If you do not have the Citrix receiver installed on your computer, you can click the **Use light version** option and apps will launch in a separate browser window.

Accessing Epic TRNPLY Environment

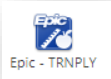
1. Once logged in to Citrix, navigate to the **Epic** folder  and select the **Epic –TRNPLY** icon. 

2. This is a copy of the training environment and the data is refreshed nightly.
3. Use class logins given to you during training or your network user ID and password.